

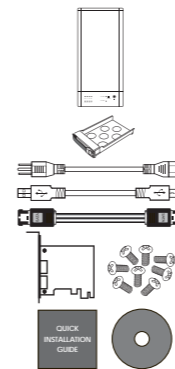

Package Contents

Item	Quantity
TR8UT+B / TR8UT+	1
Removable Tray	5
Power Cord	1
USB 3.0 Cable	1
eSATA Cable	1
2 Port eSATA PCIe Adaptor	1
Screws	1 set
Quick Installation Guide	1
CD Manual	1

Please contact Sans Digital for missing or damaged items.



Hard Drive Installation

1. Open the front hard drive panel of the unit.
2. Remove the hard drive trays by pushing the tray tab to the right and releasing the tray handle.

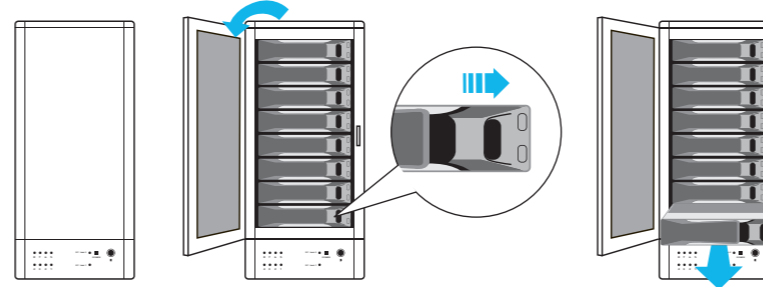

Hard Drive Installation (Continued)

3. Install each hard drive by placing them into the hard drive trays and securing them on both sides with the included screws.
4. Place the trays back into the unit and lock them in place by pushing the tray handles in.
5. Close the front hard drive panel.

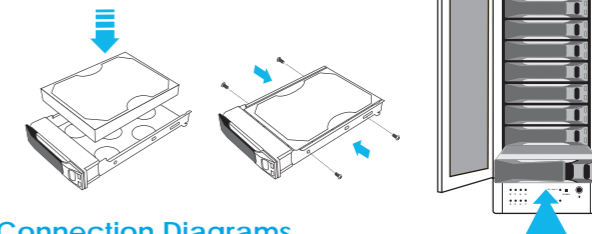

LED & Connection Diagrams

1. **Power LED** - Lights when unit is powered on.
2. **SYS1, SYS2** - Lights when RAID is ready.
3. **HDD LEDs** - Green when HDD is installed. Flashes green when HDD is being accessed. Red when HDD fails. Flashes red when HDD is being rebuilt.

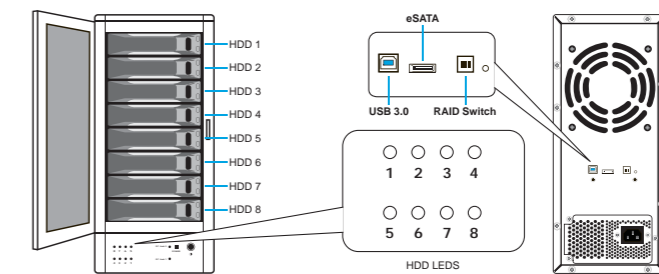

Installing PCIe Adapter Card to a Computer

Unplug AC power from computer before installation.

Insert the PCIe Card into an available PCIe slot (x1 / x4 / x8 / x16) on your computer (Step 1) and secure with screw (Step 2). Both PCIe 1.0 & 2.0 are compatible, where 2.0 provides optimal performance.

Note: Please refer to CD for driver installation.

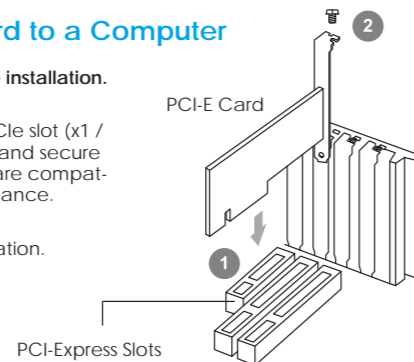

RAID Setup

1. Select the desired RAID mode by setting the RAID switch on the back of the unit.



2. Turn on the 'Power' switch while holding down the 'Reset' switch for 5 secs to complete RAID setup.



NOTE: All hard drive data will be erased during RAID setup.

Optional RAID Monitoring Utility

The unit is embedded with hardware RAID, where no additional software is required. Refer to Detail User's Manual for further RAID instructions.

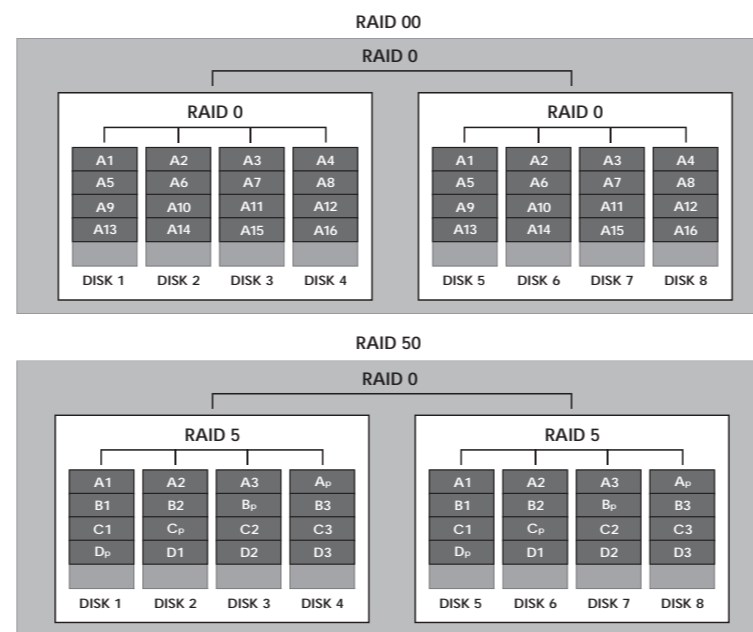

RAID system should not be used as a substitute for your data backups. A data backup strategy should be implemented to fully protect your data assets.

Other Sans Digital Products

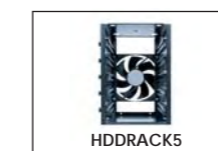

- **5-Bay IDE / SATA Hard Drive Organizing Rack**
- Designed with a 4.7" cooling fan and a hollow aluminum frame for efficient heat dissipation.
- Designed with an ON/OFF power switch, which controls the power of hard drives, when a 20-pin or 24-pin ATX power supply is connected.
- Expandable to 10-bay by stacking an additional unit on top and securing it with a tool-less screw.



- **4-Bay External RAID Enclosure**
- Access 4 hard drives while using only one cable.
- Provides RAID 5 protection with over 200MB/s in performance.
- Bundled with dual-port eSATA 6Gb/s PCIe 2.0 x1 RAID controller card.
- Supports JBOD and RAID modes on Linux, MAC and Windows; supporting Windows 7 and Snow Leopard.
- Available in black and silver finish.



- **5-Bay External RAID Enclosure**
- Access 5 hard drives while using only one cable.
- Provides RAID 5 protection with over 200MB/s in performance.
- Bundled with dual-port eSATA 6Gb/s PCIe 2.0 x1 RAID controller card.
- Supports JBOD and RAID modes on Linux, MAC and Windows; supporting Windows 7 and Snow Leopard.
- Available in black and silver finish.



- **8-Bay External RAID Enclosure**
- Two eSATA cables supporting up to 8 hard drives using Port Multiplier.
- Provides RAID 5 protection with over 200MB/s in performance.
- Supports JBOD and RAID modes on Linux, MAC and Windows; supporting Windows 7 and Snow Leopard.
- Bundled with dual-port eSATA 6Gb/s PCIe 2.0 x1 RAID controller card.
- Available in black and silver finish.

T: 1.800.980.1988 F: 1.626.322.3878 E: INFO@SANSDIGITAL.COM W: WWW.SANSDIGITAL.COM