

SANS DIGITAL | TOWERRAID TR8U+(B)



QUICK INSTALLATION GUIDE v1.0

Package Contents

Item	Quantity
TR8U+B/TR8U+	1
Removable Tray	8
Power Cord	1
USB 3.0 Cable	1
Quick Installation Guide	1
Screws	1 set

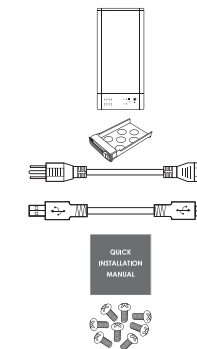

Please contact Sans Digital in case of any missing or damaged items.

Hard Drive Installation

1. Open the front hard drive panel of the unit.
2. Remove the hard drive trays by pushing the tray tab to the right and releasing the tray handle.

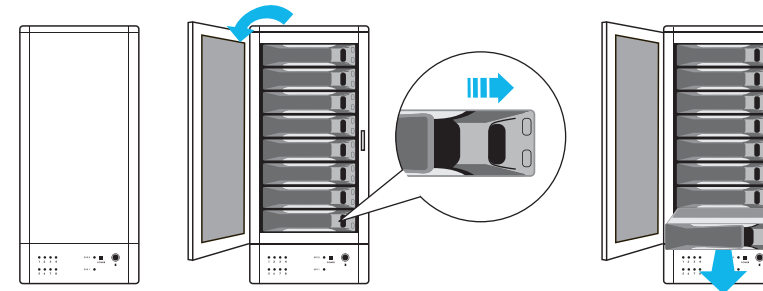

Hard Drive Installation (Continued)

3. Install each hard drive by placing them into the hard drive trays and securing them on both sides with the included screws.
4. Place the trays back into the unit and lock them in place by pushing the tray handles in.
5. Close the front hard drive panel.

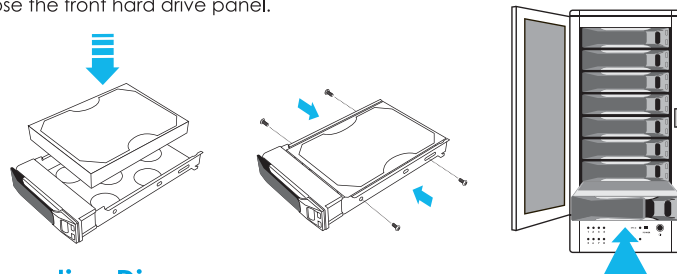

Connection Diagram

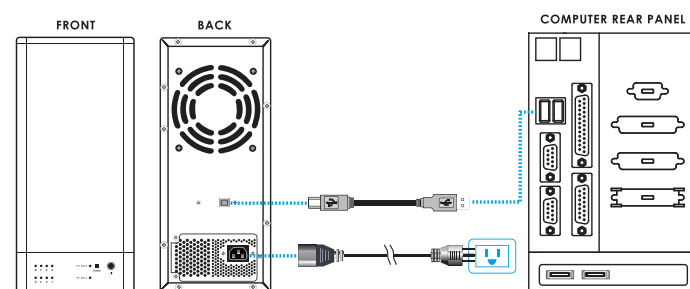

- **Power ON:** Push the power button located on the front panel to power on the unit.
- **Power OFF:** Push and hold power button more than 3 seconds to power off the unit.
- **Note:** Format hard drives in OS before use.

Other Sans Digital Products



HDDRACK5

- **5-Bay IDE / SATA Hard Drive Organizing Rack**
- Designed with a 4.7" cooling fan and a hollow aluminum frame for efficient heat dissipation.
- Designed with an ON/OFF power switch, which controls the power of hard drives, when a 20-pin or 24-pin ATX power supply is connected.
- Expandable to 10-bay by stacking an additional unit on top and securing it with a tool-less screw.



TR4UT+B / TR4UT+

- **4-Bay External RAID Enclosure**
- Access 4 hard drives while using only one cable.
- Hardware RAID 0, 1, 1+0, 3, 5 and CLONE with hot spare.
- USB 3.0 and eSATA host interfaces, supporting PC, Mac and Linux.
- Bundled with R622 2-port PCIe 2.0 x1 eSATA 6G controller card. Over 200MB/s in RAID 5 performance
- Available in black and silver finish.



TR5UT+B / TR5UT+

- **5-Bay External RAID Enclosure**
- Access 5 hard drives while using only one cable.
- Hardware RAID 0, 1, 1+0, 3, 5 and CLONE with hot spare.
- USB 3.0 and eSATA host interfaces, supporting PC, Mac and Linux.
- Bundled with R622 2-port PCIe 2.0 x1 eSATA 6G controller card. Over 200MB/s in RAID 5 performance
- Available in black and silver finish.



TR8M+B / TR8M+

- **8-Bay External RAID Enclosure**
- Two eSATA cables supporting up to 8 hard drives using Port Multiplier.
- Provides RAID 5 protection with over 200MB/s in performance.
- Supports JBOD and RAID modes on Linux, MAC and Windows; supporting Windows 7 and Snow Leopard.
- Bundled with dual-port eSATA 6Gb/s PCIe 2.0 x1 RAID controller card.
- Available in black and silver finish.

T: 1.800.980.1988 F: 1.626.322.3878 E: INFO@SANSDIGITAL.COM W: WWW.SANSDIGITAL.COM