

MS8X6 Quick Installation Guide

Hard Drive Installation

1. Remove the hard drive trays by pushing the white tray tab to the left and releasing the tray handle.
2. Install each hard drive by placing them into the hard drive trays and securing them from the bottom with the included screws.
3. Place the trays back into the unit and lock them in place by pushing the tray handles in.

Note: If the screws are not properly fastened the hard disk may be pushed towards the back of the unit and the tray handle will not open properly.

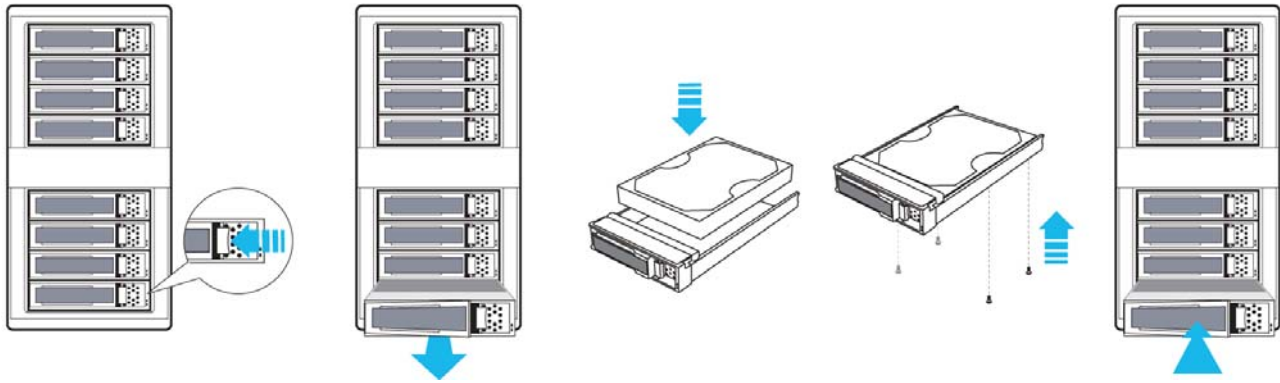

Product Diagrams

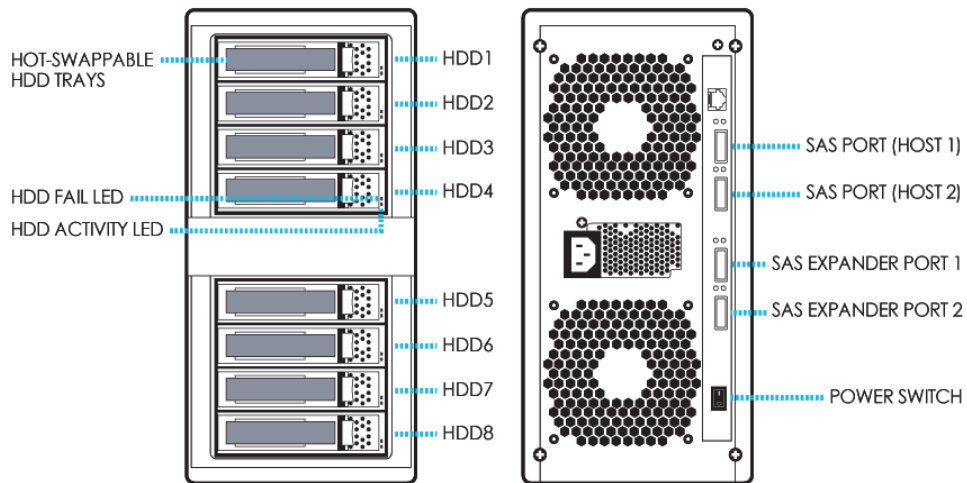

Connection Diagrams

Basic Connection

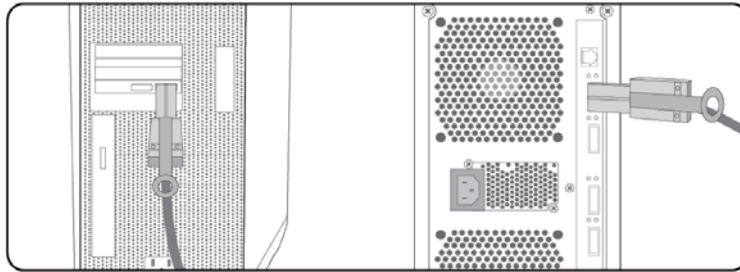

Performance Connection

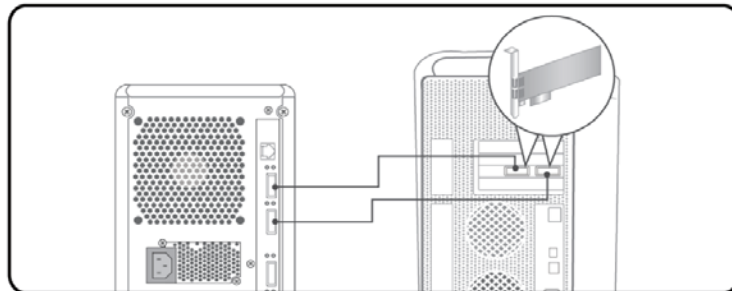

Failover Connection

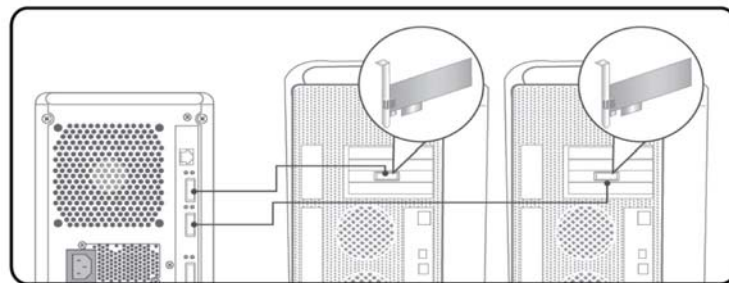

Expander Port Connection

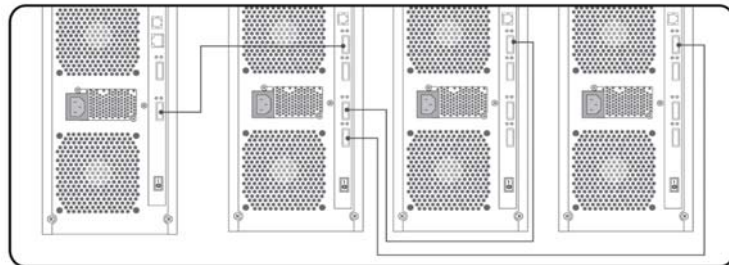

LED Indicators



LED	Normal Status	Performance Indication
Activity LED (BLUE)	<p>When the activity LED is illuminated, there is I/O activity on that disk drive.</p> <p>When the LED is dark; there is no activity on that disk drive.</p>	N/A
Fault / Link LED (RED / GREEN)	<p>When the fault LED is solid illuminated, there is no disk present.</p> <p>When the link LED is solid illuminated, there is a disk present.</p> <p>The link LED blinks slowly (one blink / 2 secs when the host powers off)</p>	<p>When the fault LED is off, that disk is present and status is normal.</p> <p>When the fault LED is blinking slowly (2 blinks / sec), that disk drive has failed and should be hot-swapped immediately.</p> <p>When the activity LED is illuminated and fault LED is blinking fast (10 blinks / sec), there is rebuilding activity on that disk drive.</p>